



**HUON VALLEY
COUNCIL**



Summary of Community Engagement

SHIPWRIGHTS POINT TOILET REFURBISHMENT HUON HIGHWAY PORT HUON

CONTENTS

1. EXECUTIVE SUMMARY	3
2. BACKGROUND	3
3. ENGAGEMENT FEEDBACK.....	4
4. RECOMMENDATION	<u>5</u>
APPENDIX 1	<u>6</u>
APPENDIX 2.....	<u>12</u>

Shipwrights Point Toilet Refurbishment Huon Highway, Port Huon

Summary of Community Engagement

Publication Date: [Council Meeting Date]

Council Resolution: [Resolution No.]

Contact Details:

Huon Valley Council

Phone: (03) 6264 0300

Email: hvc@huonvalley.tas.gov.au

Post: Huon Valley Council
PO Box 210
HUONVILLE TAS 7109

1. EXECUTIVE SUMMARY

This community engagement was conducted at the “Consult Level” in accordance with Council’s Community Engagement Framework.

For the purposes of the engagement, feedback on the proposed project was invited from the community for a period of three weeks (15 August – 5 September)

This report summarises feedback received throughout the engagement period. A total of 112 responses to the request for feedback were received. Copies of each of the responses received are included in Appendix 1 of this report.

2. BACKGROUND

The development of a Master Plan for Shipwrights Point in 2009 by Inspiring Places was in recognition of the importance of the reserve to the community and its increasing popularity with visitors.

It was intended that the plan will provide Council and the community with a strategic tool for future upgrading and management of the reserve, in line with the original intent of the purchase of the site.

Refurbishment of the Shipwrights Point toilet facility will include a new roof, interior and exterior paint, dual flush cisterns and new cubicle walls/doors.

Community members were invited to share their preference of the proposed roof design and were also asked what other elements they would like to see in the future. The feedback forms also provided community members with an opportunity to be kept ‘up-to-date’ on this project by including their email address.

Council will undertake the refurbishment of the existing Shipwrights Point toilet facility which is included in Council’s 2019/2020 Asset Renewal Plan.

Engagement Technique	Date	Reach
Hard copy feedback forms at Port Huon Trading Post, Port Huon Sports Centre and Huon Valley Council Customer Service Centre in Huonville	15 August 2019 – 05 September 2019	16 completed
Community Noticeboards	15 August 2019 – 05 September 2019	Huonville, Franklin, Geeveston and Dover
Huon Valley Council Website - Community Engagement ‘Have Your Say’ page	15 August 2019 – 05 September 2019	263 page views 96 online submissions
Facebook	15 August 2019 – 05 September 2019	7670 People Reached 1387 Engaged with Posts

3. ENGAGEMENT FEEDBACK

As indicated in the Summary to this Report a total of 112 responses to the request for feedback were received during the engagement period.

The feedback received made a number of suggestions. Feedback received has been summarised in a table in the form of feedback received, comments and a recommended response, attached as Appendix 1.

The consultation asked the following questions:

- Which roof line do you prefer?
- What other facilities or features would you like to see at Shipwrights Point the future?

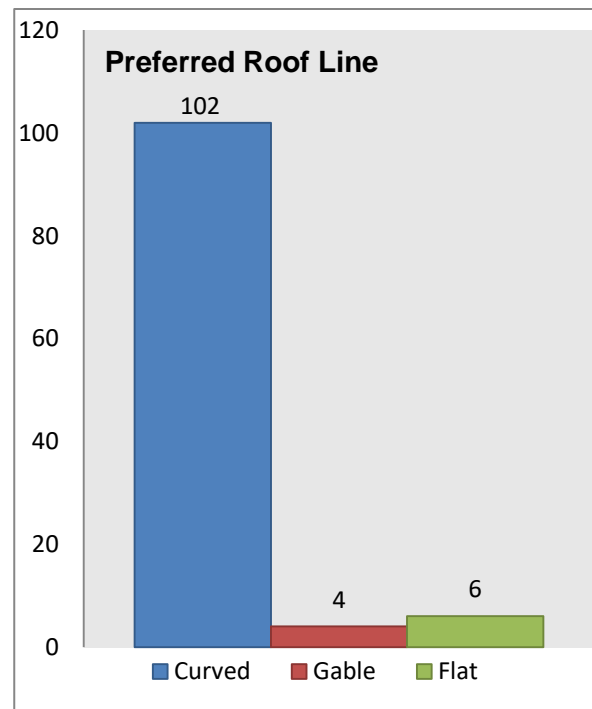

Some of the identified responses for this project suggested the inclusion of:

- Infant change table
- Hand washing facilities including soap dispenser
- Improved lighting

The Project Team have reviewed the feedback received and noted that further requests were made for seating, shade, drinkable water and extra playground components. These will be considered as funding becomes available, as future elements would require a new capital budget allocation.

4. RECOMMENDATION

Based on the feedback received the Project Team will recommend that Council approve the Curved Roof Line in Appendix 3.

Appendix 1

#	Curved	Gable	Flat	Community Comments	Council Comments
1.	Curved			A rubbish bin at the boat ramp area please. There is a lot of littering there and I don't recall seeing a bin last time I was there. I like the curved roof, I think it will suit the sailing theme with the yacht club there, curved roof looks like a sail full of wind!	Extra bins will be a future consideration subject to funding
2.		Gable			No comment required
3.	Curved			Safe path to the jetty Seating to take in the view	Extra seating will be a future consideration subject to funding
4.	Curved				No comment required
5.	Curved			BBQ facilities with shelter, bike-scooter track.	Comment noted for future improvements as funding becomes available Existing bike track within playground area
6.	Curved			Minimal	No comment required
7.	Curved			Solar shower, pay as you go 2x\$1 timed meter	Comment noted - outside the scope of this project
8.	Curved			BBQ area / BBQ area cleaned up Children's playground yo be kept tidy etc	Referred to Council's maintenance program
9.	Curved				No comment required
10.	Curved				No comment required
11.	Curved				No comment required
12.	Curved				No comment required
13.	Curved				No comment required
14.	Curved			Shower block for campers	Comment noted - outside the scope of this project
15.	Curved				No comment required
16.	Curved				No comment required
17.	Curved			Flatter area to camp - all it would take is a couple of runs with a wide blade	Comment noted - outside the scope of this project
18.	Curved			Plenty of rubbish bins, seats, dog poop bags and perhaps a water bottle filling facility, if not already there or thought of. I haven't dropped in for a while, so I can't remember, but it's a lovely area. ☺	Extra seating and bins will be a future consideration subject to funding. Comment for dog bags/bin has been referred to relevant department for future improvements.

19.	Curved			Some shade for cars to park under	Extra shade will be a future consideration subject to funding
20.	Curved				No comment required
21.	Curved				No comment required
22.	Curved			How about a cable car?	Comment noted - outside the scope of this project
23.	Curved			We would like to see the affordable camping continue this could include a dedicated fire pit installed in an appropriate location which would bring campers together and stop the damage being done to the camping ground by individual caravan campfires.	Comment noted - outside the scope of this project
24.	Curved				No comment required
25.	Curved				No comment required
26.	Curved				No comment required
27.	Curved				No comment required
28.	Curved				No comment required
29.	Curved			Better access road to the boat ramp (the current road has deep washouts).	Comment noted - outside the scope of this project
30.	Curved			Interpretation of the area's history.	Comment noted for future improvements as funding becomes available
31.			Flat	Soap for handwashing. Given that council puts toilet paper in council toilets every day how much extra would it cost to cover a basic thing like this.	Comment noted - inconsistent with operational efficiency
32.	Curved				No comment required
33.	Curved			More things to do at the park. Make it bigger.	Comment noted - outside the scope of this project
34.	Curved			Great to see this block getting some love. I hope the lighting will be improved and that it will be well maintained.	
35.	Curved				No comment required
36.	Curved			More seats, picnic tables on grassed area	Extra seating and tables will be a future consideration subject to funding
37.	Curved				No comment required
38.	Curved			Safe access to the river for small craft, kayaks etc as outlined to Council at recreation focus meeting. Sensor solar lights on the refurbished toilets and barbecue area.	Comment noted - outside the scope of this project Comment noted - inconsistent with operational efficiency

39.	Curved			More bins at the BBQs and perhaps one at the boat ramp. Yacht club jetty and one near the blackwater drop. Increase the pickup cycle or at least empty before a long weekend. (Based on observation of local behaviour)	Extra bins will be a future consideration subject to funding
40.	Curved			Easier access into the water for recreational boats (ie kayaks) - beachhead or small boat ramp.	Comment noted - outside the scope of this project
41.	Curved				No comment required
42.	Curved			I have seen at a few parks a climbing pyramid. Single 200mm diameter pole 4 meters or more high, with a rope system around it. Like a rope Tee pee for the bigger kids to climb.	Comment noted - outside the scope of this project
43.	Curved			I think that it fine just the way it is	
44.			Flat	'Looks' are surely not the only factor to consider in choosing roof design: I'd like to see info on cost available with the image to enable a more considered choice.	Comment noted
45.	Curved				No comment required
46.	Curved				No comment required
47.			Flat	Drinkable water. Maybe a bubbler or Drink bottle refill station.	Extra features will be a future consideration subject to funding
48.	Curved			More level camping areas please. Drinking water tap near BBQ, not the dump point tap. A sign to stop people using the dump point water to drink. improve the water run off on the dirt roads.	Comment noted - outside the scope of this project Referred to Council's maintenance program
49.		Gable		An information panel about local Indigenous Australians' history in the area.	Comment noted for future improvements as funding becomes available
50.	Curved			Bike park. Exercise park. Water park	Existing bike track within playground area Comment noted - outside the scope of this project
51.			Flat	More trees/gardens.	Comment noted for future improvements as funding becomes available
52.	Curved			Nothing! I think the facilities there are great, we love going there. The only thing	

				I would like to see is regular council inspections to ensure visitors aren't abusing the privilege of having such a great location (fires, rubbish, mini bikes etc).	
53.	Curved				No comment required
54.	Curved			Rain water collection off the roof used as part of the park irrigation.	Comment noted - inconsistent with operational efficiency
55.	Curved				
56.	Curved			No public bbq or RV site should exist without a recycling bin.	Comment noted - outside the scope of this project
57.	Curved				No comment required
58.	Curved				No comment required
59.	Curved				No comment required
60.	Curved				No comment required
61.	Curved				No comment required
62.	Curved				No comment required
63.			Flat		No comment required
64.	Curved				No comment required
65.		Gable		Improved waste disposal facilities, including grey water waste from caravans, etc. Power availability on a pay for use basis. Better lighting.	Comment noted - outside the scope of this project
66.	Curved				No comment required
67.	Curved			Dog park pls :)	Existing dog exercise area within site
68.	Curved				No comment required
69.		Gable		A gable roof may facilitate solar panel installation. The roof should also collect rain water for uses. Be clever with this facility!	Comment noted - inconsistent with operational efficiency
70.	Curved				No comment required
71.	Curved				No comment required
72.	Curved				No comment required
73.	Curved			Lies in the landscape better , the curves of the river and the rolling hills.	
74.	Curved			Rubbish bins down near bush line to gather blown away trash from campers - also a dog bag roll & doggy waste disposal bin - Thx	Comment noted for future improvements as funding becomes available
75.	Curved				No comment required
76.	Curved				No comment required
77.	Curved			A shower please	Comment noted - outside the scope of this project

78.	Curved			Fitness equipment with instructions	Comment noted - outside the scope of this project
79.	Curved			Off lead fenced dog exercise area please!	Comment noted - outside the scope of this project
80.	Curved			Memorial wall about the Apple industry the pulp mill and the regatta days	Comment noted for future improvements as funding becomes available
81.	Curved			Maybe showers for the campers and pickers that are in the area over the summer. I work at the Visitor Centre and lack of showers in the area for campers etc is something that gets mentioned a lot. Perhaps some more shade area for people that use the park. It's a great place and should be used more often. Perhaps a fitness equipment area, a dog exercise area too.	Comment noted for future improvements as funding becomes available
82.	Curved				No comment required
83.	Curved			Shelter Playground Off leash dog exercise area	Comment noted for future improvements as funding becomes available Existing dog exercise area within site
84.	Curved				No comment required
85.	Curved				No comment required
86.	Curved				No comment required
87.	Curved				No comment required
88.	Curved				No comment required
89.	Curved				No comment required
90.			Flat	But wouldn't you do the cheapest one anyway so you can spend the saved money on other things like a few new BBQ And seats dotted over the park. there are never enough seats not just at shipwrights Anywhere (but I haven't been there in a while there might be new BBQ) Thank you	Extra seating will be a future consideration subject to funding
91.	Curved				No comment required
92.	Curved				No comment required
93.	Curved				No comment required
94.	Curved			Water bubbler in playground	No comment required
95.	Curved				No comment required

96.	Curved				No comment required
97.	Curved				No comment required
98.	Curved				No comment required
99.	Curved			More BBQ's and tables with shelters, they could be hired out for birthday's, Xmas etc.	Comment noted for future improvements as funding becomes available
100.	Curved			New bins New seating Public showers	Comment noted for future improvements as funding becomes available
101.	Curved				No comment required
102.	Curved				No comment required
103.	Curved				No comment required
104.	Curved			Change tables and disposal	Comment noted for future improvements as funding becomes available
105.	Curved			Close in BBQ shelter from weather	Comment noted - outside the scope of this project
106.	Curved				
107.	Curved			Extensions to yacht club	Comment noted - outside the scope of this project
108.	Curved			Keep it as it is. Short term stays close to Hobart. Good for long weekend etc.	
109.	Curved				No comment required
110.	Curved				No comment required
111.	Curved				No comment required
112.	Curved				No comment required

Appendix 2

Social Media Post Performance – statistics as of 16 August 2019

Huon Valley Council
16 August · 🌐

Curved, gable or flat? Have your say on the new roof design for the toilet block refurbishment at Shipwrights Point in Port Huon.

Complete a survey by 5 September at the following locations:

- On the Huon Valley Council website: [huonvalley.tas.gov.au/.../shipwrights-point-toilets-refurbish.....](http://huonvalley.tas.gov.au/.../shipwrights-point-toilets-refurbish...) See more

HAVE YOUR SAY
www.huonvalley.tas.gov.au/haveyoursay



Shipwrights Point Toilets Refurbishment
Feedback sought on new roof

The toilet block at Shipwrights Point on the Huon Highway in Port Huon will undergo a refurbishment.

Renovations will include:

- Interior and exterior painting
- New cubicle walls/doors
- New dual-flush cisterns
- Roof Replacement

We'd like to hear your thoughts on the three design options for the new roof.

Complete a survey online
huonvalley.tas.gov.au/haveyoursay

Complete a survey at
Council's Customer Service Centre

For more information
Community Engagement Officer
Phone: 6264 0300
hvc@huonvalley.tas.gov.au

Performance for your post

4,827 People Reached

175 Reactions, comments & shares 📊

34 Like	28 On post	6 On shares
4 Love	4 On post	0 On shares
130 Comments	112 On Post	18 On Shares
7 Shares	7 On Post	0 On Shares

871 Post Clicks

135 Photo views	73 Link clicks	663 Other Clicks 📊
---------------------------	--------------------------	------------------------------

NEGATIVE FEEDBACK

2 Hide post **1** Hide all posts

0 Report as spam **0** Unlike Page

Reported stats may be delayed from what appears on posts

4,827
People reached

1,046
Engagements

[Boost Post](#)

Diane Reed, Tess Bennett and 29 others 105 Comments 7 shares

Huon Valley Council
3 September at 17:48 · 🌐

👉 Last chance to have your say!

Vote for a curved, gable or flat roof design for the Shipwrights Point toilet block in Port Huon by completing a survey before this Thursday 5 September:

- On the Huon Valley Council website: huonvalley.tas.gov.au/.../shipwrights-point-toilets-refurbish...
- Port Huon Trading Post at 4478 Huon Highway
- Council's Customer Service Centre at 40 Main Street, Huonville

Choose whichever style you think looks best knowing all three options fall within the allocated budget for the toilet block refurbishment.

When completing the survey you'll also have the chance to make suggestions for future improvements at the site.

Your feedback is appreciated!

MEDIA RELEASE
August 2019

Have Your Say: New roof for Shipwrights Point toilet

Huon Valley Council invites local residents to Have Your Say on refurbishment works for the toilet block located at Shipwrights Point on the Huon Highway, Port Huon.

The refurbishment will include:

- Interior and exterior painting
- New cubicle walls/doors
- New dual-flush systems
- Roof replacement

Council is seeking community feedback on the three design options for the new roof: curved, gable, and flat. "Have your say on which roof style you prefer by submitting a survey," said Huon Valley Council Mayor Bec Enders.

Surveys are available at the following locations:

- Huon Valley Council website, huonvalley.tas.gov.au, select "Have Your Say"
- Council's Customer Service Centre at 40 Main Street, Huonville
- Port Huon Trading Post at 4478 Huon Highway

Use your choice on which looks best," said Cr Enders. "Each option falls within the allocated \$50,000 for the refurbishment." Huon Valley Council's 10 Year Asset Renewal Program is viewable on Council's website under "Plans and Strategies": <http://www.huonvalley.tas.gov.au/council/reports-and-publications/plans-and-strategies>

The Shipwrights Point reserve is an important place for residents and is also becoming popular for visitors," said Cr Enders. "It is important that the toilet block design reflects the wishes of the community, so we encourage people to have their say before the close date of 5 September. As part of this consultation people are invited to share their ideas for future facilities or features at the site, which will be considered as funds become available.

Your feedback will be included in a report presented to Council at an Ordinary Meeting.

For more information: Mayor Bec Enders (03) 6264 0300

Communications & Media Officer
Huon Valley Council
communications@huonvalley.tas.gov.au

HAVE YOUR SAY
www.huonvalley.tas.gov.au/haveyour-say



**Shipwrights Point Toilets Refurbishment
Feedback sought on new roof**

Renovations will include:

- Interior and exterior painting
- New cubicle walls/doors
- New dual-flush systems
- Roof Replacement

We'd like to hear your thoughts on the three design options for the new roof.

Complete a survey online
huonvalley.tas.gov.au

Complete a survey at
Council's Customer Service Centre

For more info
Community Engagement Officer
Phone: 6264 0300
huonvalley@huonvalley.tas.gov.au

Performance for your post

2,843 People Reached

37 Reactions, comments & shares

7 Like	7 On post	0 On shares
1 🤔 Haha	1 On post	0 On shares
26 Comments	23 On Post	3 On Shares
3 Shares	3 On Post	0 On Shares

304 Post Clicks

87 Photo views	22 Link clicks	195 Other Clicks
-----------------------	-----------------------	-------------------------

NEGATIVE FEEDBACK

1 Hide post	0 Hide all posts
0 Report as spam	0 Unlike Page

Reported stats may be delayed from what appears on posts

2,843 People reached **341** Engagements **Boost Post**

👍👍 Sally Edna, Danny Bell and 6 others 17 Comments 3 shares



**HUON VALLEY
COUNCIL**

**PROPOSED ROOF DESIGN
SHIPWRIGHTS POINT
TOILET REFURBISHMENT**

**HUON HIGHWAY
PORT HUON**



Meeting: 30.10.2019
Item Number: 19.023/19*
Page 14 of 14