

ISSUED FOR BUILDING APPLICATION.

EXISTING DOORS NO NEW WORKS

MODIFIED LANDING TO ACCOMODATE LIFT DOORWAY / STRUCTURAL OPENING.
(POSITION OF NEW STEPS SHOWN IN BLUE).

NOMINATED WALL FINISH TREATMENT TO WALLS OF LIFT SHARFT TO BE NOMINATED
BY CLIENT. (NEW WALLS SHOWN BLACK).

NOTE : LIFT DOORS AND
FRAME TO ACHIEVE A 30%
LUMINANCE CONTRAST IN
ACCORDANCE WITH CLAUSE
13.1 OF AS1428.1-2009.

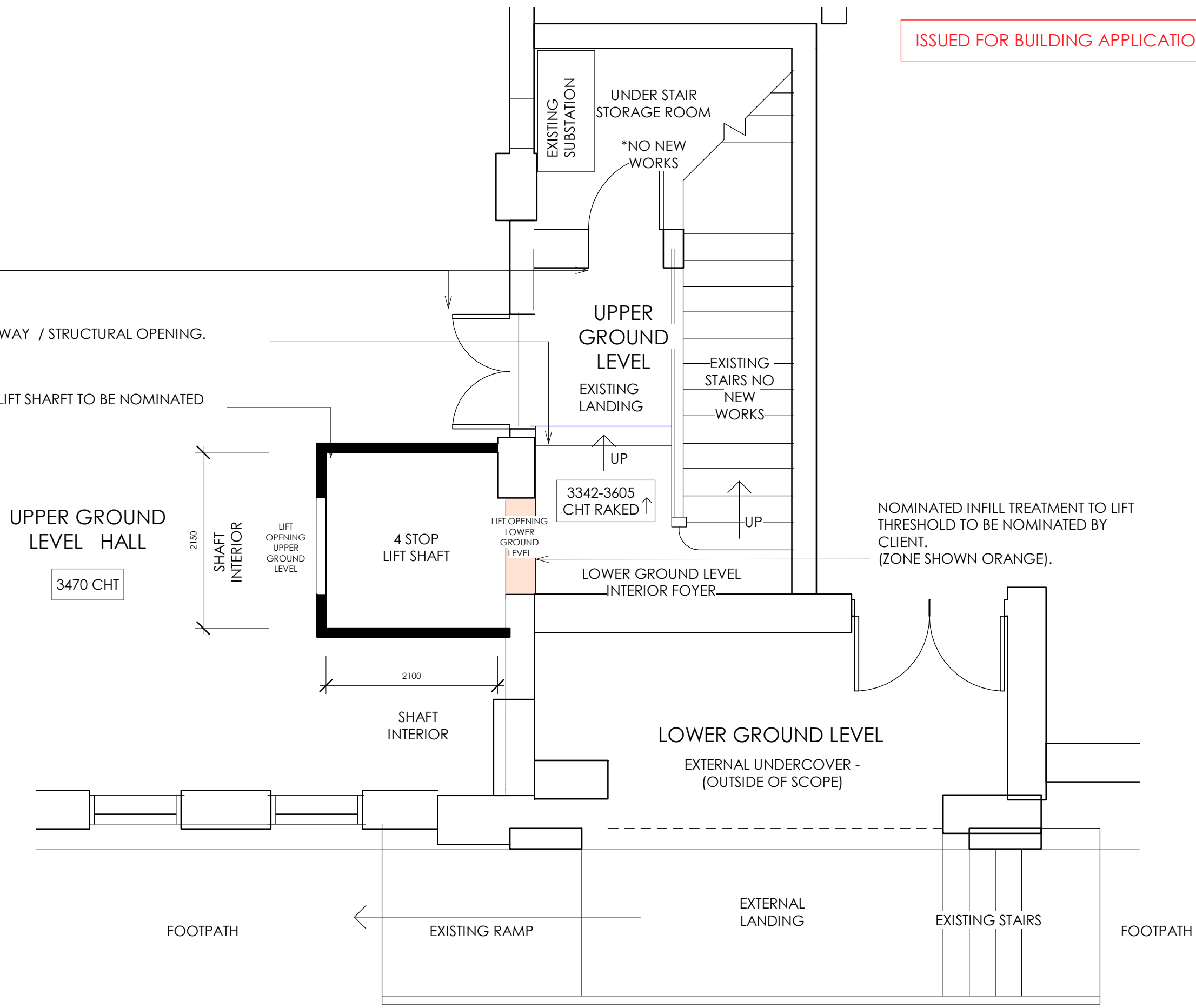

A
-
PROPOSED LIFT CAR 1:50
FLOOR PLAN
UPPER GROUND LEVEL +
LOWER GROUND LEVEL



ACCESS SOLUTIONS
86 BURWOOD DRIVE, BLACKMANS BAY, TAS 7052.
PO BOX 161 KINGSTON
03 6229 2476
INFO@ACCESS-SOLUTIONS.COM.AU
WWW.ACCESS-SOLUTIONS.COM.AU

**ACCREDITATION COMPLIANCE
NUMBER - CC752Q**

CLIENT - HUON VALLEY COUNCIL
PROJECT - GEEVESTON TOWN HALL NEW LIFT CAR
PROJECT ADDRESS GEEVESTON TOWN HALL, 15 CHURCH ROAD, GEEVESTON
PROJECT STAGE - DEVELOPMENT APPLICATION - NOT FOR CONSTRUCTION

DRAWING NOTES -
PLANNING APPLICATION - NOT FOR CONSTRUCTION.
ALL MEASUREMENTS TO BE CHECKED ON SITE.
DO NOT MEASURE OFF PLANS. ANY DISCREPANCIES TO BE
REPORTED TO THE OFFICE VIA EMAIL.

TITLE PROPOSED - UPPER GROUND LEVEL + LOWER GROUND LEVEL PLAN
SCALE 1:50 @ A3
DATE 11.05.2021
DWG No. A004
REVISION ISSUED FOR BUILDING APPLICATION.

© copyright ACCESS SOLUTIONS

**DO NOT SCALE DRAWINGS. IF
IN DOUBT - ASK.**

CERTIFIER TO CHECK & ADVISE ON DRAWING. CERTIFIER
SIGN OFF PRIOR TO CONSTRUCTION TO ENSURE THAT THE
DESIGN COMPLIES WITH THE BUILDING CODE OF AUSTRALIA
+ RELEVANT AUTHORITIES AS REQUIRED. COPYRIGHT OF
ACCESS SOLUTIONS PTY LTD.